

# Emergency Data Sheet for EVAC West Observing Site

In an emergency, 911 can be used with cell phones even when roaming. Below are the maps and coordinates for **Vekol Road**.

**Latitude: 32° 47' 54" N      Longitude: 112° 15' 14" W**

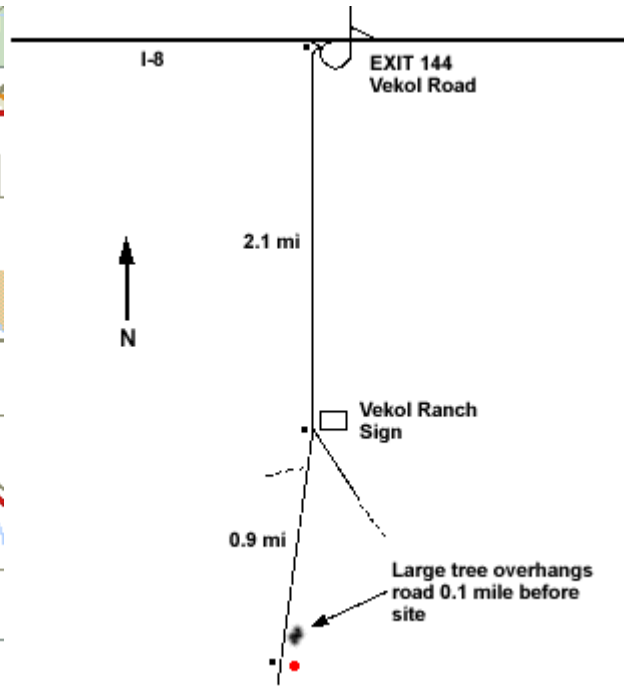
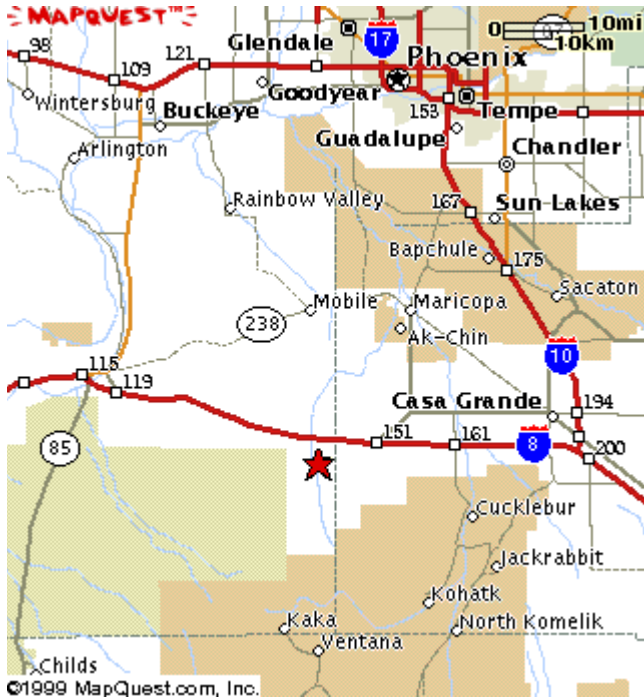

The nearest 24-hour medical facility is **Casa Grande Regional Medical Center**. It is located at exit 194 on I-10 east of Casa Grande on highway 287.

**1800 East Florence Boulevard Casa Grande, AZ 85222**

